

# Creekside

at Turkey Creek

MLS 303278  
Homesite 80  
11750 NW 60<sup>th</sup> Terr

# \$148,900

Move-in Ready



## The Riley

1,186 Sq. Ft. 3BR 2BA.

Duration is offering up to \$1,000 of the purchase price towards the buyer closing cost on this home. Additionally, all of our Creekside homes are eligible for the USDA zero down payment program. We also provide a 1yr/10yr warranty on your new energy efficient home.

This 3Br – 2Ba home comes with a garage and we include upgraded appliances (smooth top range and microwave) in your home. The kitchen and baths are fitted with custom cabinets and we've installed ceramic tile and wall to wall carpeting throughout. You'll love the plant shelves, archways and double french doors opening to your covered lanai.

Your new home comes with a lifestyle... Turkey Creek, gated community, features a pool, park/playground, tennis courts, restaurant, golf course and green space; and is located just minutes from restaurants and shopping in NW Gainesville and historic downtown Alachua.

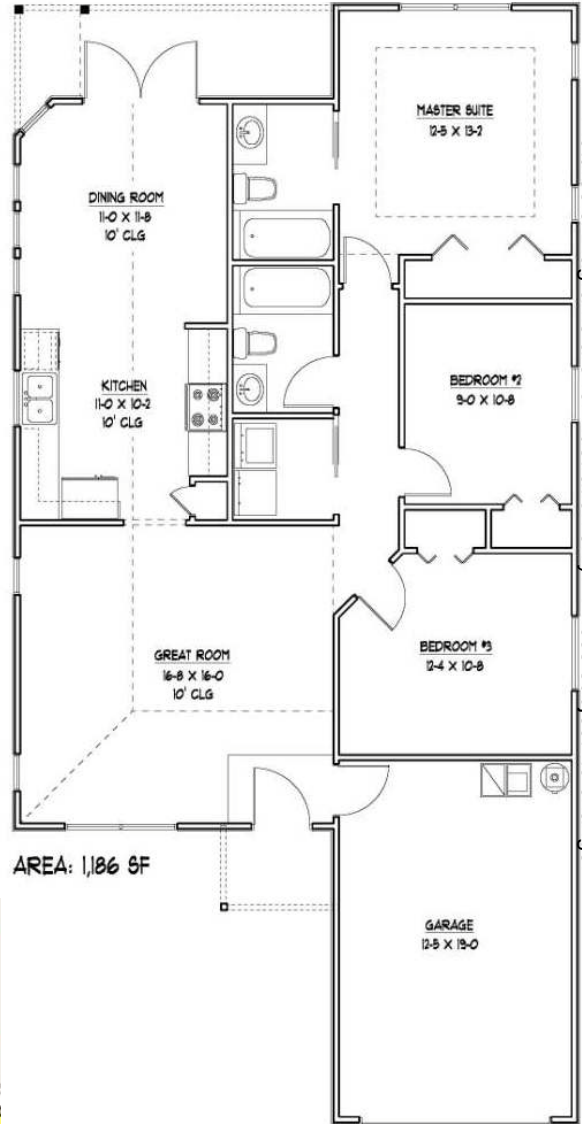

Pictures & Diagrams are for illustration only. Prices subject to change.

AREA: 1,186 SF

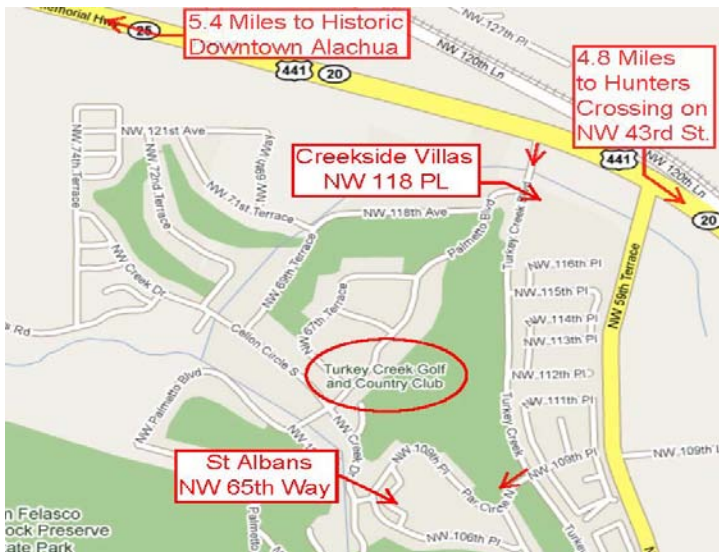

[www.Durationbuilders.com](http://www.Durationbuilders.com)  
[bjones@durationbuilders.com](mailto:bjones@durationbuilders.com)

386-462-0511

352-494-3129

527 Turkey Creek, Alachua, FL 32615